

ENTRY NO. CU28 Date 22.06.92  
 Cyclotron Model MC 35  
 Institution Medizinische Hochschule Hannover  
 Address Konstanty-Gutschow-Str. 8 D-3000 Hannover 61  
 Tel 0511/5321 Telex  
 Fax 0511/5322315 EMAIL  
 In Charge: Dr. Junker Reported by: Dr. Helmeke

**HISTORY**

MILESTONE DATES:  
 Installation 1976/77 First Beam 21.01.1977  
 DESIGN/CONSTRUCTION BY: Scanditronix  
 COST: Accelerator Facility  
 FUNDED BY:

**STATUS**

STAFF: Operators 1 Engineers ~~XXXXXX~~ Technicians 1  
 BUDGET: Machine Funded by  
 TIME DISTRIBUTION: (e.g. basic research, isotope production, maintenance, etc.)  
 (a) isotope production 90 %  
 (b) maintenance 7 %  
 (c) tests (cyclotron, targets) 3 %  
 (d) %  
 (e) %

**CHARACTERISTIC BEAMS**

Accelerated Ions	E/A (MeV/u)	Current(part $\mu$ A)	
		Internal	External
(a) Protons	35		65
(b) Deuterons	18		65

1991  $\mu$ A-hours on target: 205

**FACILITIES**

SHIELDED AREA: Fixed  $\approx$  100 m<sup>2</sup> Moveable m<sup>2</sup>  
 Target Stations: 2 No. Served At Same Time: 1  
 OTHER FACILITIES:

**REFERENCES/NOTES**

(a) target stations: solids-3 positions/Gas-6 positions  
 (b) He - 3 and He 4 beam is available too

**PLAN VIEW OF FACILITY, COMMENTS**

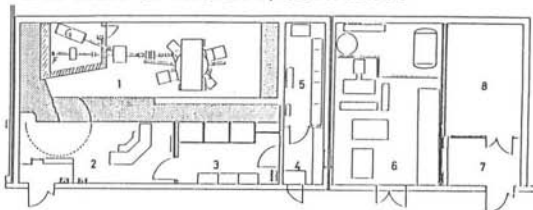

- 1 ZYKLOTRON UND BESTRAHLUNGSRAUM
- 2 SCHALTRAUM MIT EINGANGSSCHLEUSE
- 3 TARGET-LABOR
- 4 TARGET-VORBEREITUNG
- 5 HILFSMASCHINENRAUM (Zyklotronelektronik)
- 6 MASCHINENRAUM (Stromversorgung Zyklotron, Lüftung, Kühl- und Abwasser)
- 7 VORBEREITUNG FÜR PATIENTEN
- 8 APPLIKATIONSRAUM

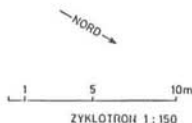

ENTRY NO. CU29 Date  
 Cyclotron Model BC 1710  
 Institution Institute of Nuclear Chemistry, KFA Jülich  
 Address 5170 Jülich, Germany  
 Tel 2461-614141 Telex 833556 KFA D  
 Fax 2461-612535 EMAIL  
 In Charge: Prof. G. Stöcklin Reported by: Dr. S.M. Qaim

**HISTORY**

MILESTONE DATES:  
 Installation January 1987 First Beam April 1987  
 DESIGN/CONSTRUCTION BY: Japan Steel Works  
 COST: Accelerator DM 3.3 M Facility DM 1.5 M (both 1987 values)  
 FUNDED BY: Federal Government

**STATUS**

STAFF: Operators 2 Technicians  
 BUDGET: Machine DM 50,000 Funded by Federal Govt. (running costs)  
 TIME DISTRIBUTION: (e.g. basic research, isotope production, maintenance, etc.)  
 (a) Isotope production 100 %  
 (b) %  
 (c) %  
 (d) %  
 (e) %

**CHARACTERISTIC BEAMS**

Accelerated Ions	E/A (MeV/u)	Current(part $\mu$ A)	
		Internal	External
(a) Protons	17		50
(b) Deuterons	10		40

1991  $\mu$ A-hours on target: 8200

**FACILITIES**

SHIELDED AREA: Fixed  $\approx$  350 m<sup>2</sup> Moveable m<sup>2</sup>  
 Target Stations: 1 No. Served At Same Time:  
 OTHER FACILITIES: 6 Hot cells  
 Radiochemical and Radiopharmaceutical laboratories  
 PET, SPECT, Radioagronomy laboratories

**REFERENCES/NOTES**

(a)  
 (b)

**PLAN VIEW OF FACILITY, COMMENTS**