

ENTRY NO. CU114 Date
 Cyclotron Model CTI RPS 112
 Institution The Methodist Medical Center of Illinois
 Address Peoria, IL, USA
 Tel (309)671-2738 Telex
 Fax (309)671-5185 EMAIL
 In Charge: S. Zigler Reported by: S. Zigler

HISTORY
 MILESTONE DATES:
 Installation Dec. 1990 First Beam Jan-Feb. 1991
 DESIGN/CONSTRUCTION BY: Philip Swager Assoc.
 COST: Accelerator Facility
 FUNDED BY: Internally

STATUS
 STAFF: Operators 1 Technicians 0
 BUDGET: Machine Internally
 TIME DISTRIBUTION: (e.g. basic research, isotope production, maintenance, etc.)
 (a) Clinical Isotope Production 95 %
 (b) Maintenance (Preventative and Service) 5 %
 (c) %
 (d) %
 (e) %

CHARACTERISTIC BEAMS

Accelerated Ions	E/A (MeV/u)	Current (part μ A)	
		Internal	External
(a) H ⁻	11	200 (H ⁺)	100 (p)
(b)			

1991 μ A-hours on target: 2250

FACILITIES
 SHIELDED AREA: Fixed m² Standard Shields Moveable m²
 Target Stations: 4 No. Served At Same Time: 2
 OTHER FACILITIES: CLINICAL MEDICAL IMAGING: SIEMENS 921 SCANNER

REFERENCES/NOTES
 (a)
 (b)

PLAN VIEW OF FACILITY, COMMENTS

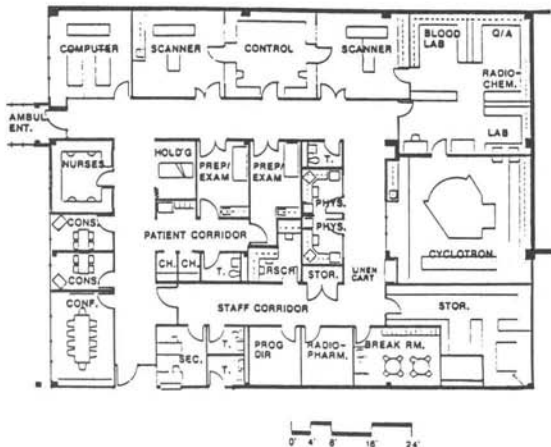

ENTRY NO. CU116 Date
 Cyclotron Model SIEMENS/CTI RPS 112
 Institution N. CALIF. PET IMAGING CENTER
 Address 3195 FOLSOM BLVD, SACRAMENTO, CA 95816
 Tel 916-737-3200 Telex
 Fax 916-737-6203 EMAIL
 In Charge: H.C. PADGETT Reported by: H.C. PADGETT

HISTORY
 MILESTONE DATES:
 Installation MAY 1992 First Beam JUNE 1992
 DESIGN/CONSTRUCTION BY: CTI CYCLOTRON SYSTEMS
 COST: Accelerator \$1,000,000 Facility \$500,000
 FUNDED BY: PRIVATE

STATUS
 STAFF: Operators 2 Technicians 1
 BUDGET: Machine Internally
 TIME DISTRIBUTION: (e.g. basic research, isotope production, maintenance, etc.)
 (a) CLINICAL ISOTOPE PROD, IN-HOUSE 90 %
 (b) CLINICAL ISOTOPE PROD, DISTRIBUTION 10 %
 (c) %
 (d) %
 (e) %

CHARACTERISTIC BEAMS

Accelerated Ions	E/A (MeV/u)	Current (part μ A)	
		Internal	External
(a) H ⁻	11	100	100
(b)			

1991 μ A-hours on target: -

FACILITIES
 SHIELDED AREA: Fixed 0 m² Moveable 0 m²
 Target Stations: 4 No. Served At Same Time: 2
 OTHER FACILITIES: CLINICAL MEDICAL IMAGING: SIEMENS 921 SCANNER

REFERENCES/NOTES
 (a)
 (b)

PLAN VIEW OF FACILITY, COMMENTS

