

FEL 2012 in Nara/Kyoto



Hosted by SPring-8/Kyoto University

Conference Dates & Venue

August 26-31, 2012

Nara, Japan



Nara occupies an important position in history as it was the location of Japan's first state.

The ancient capital, Nara Heijo-kyo was established in 710 A.D. It was an international city modeled on the capital of Tang Dynasty China, Changan.

This long history means that Nara is also the home of several World Heritage sites, such as Todaiji Temple and Horyuji Temple. The prefecture also has numerous Buddhist works of art and architecture that have been classified as National Treasures or Important Cultural Assets.





FOODS

CONFERENCE!

Conference Location

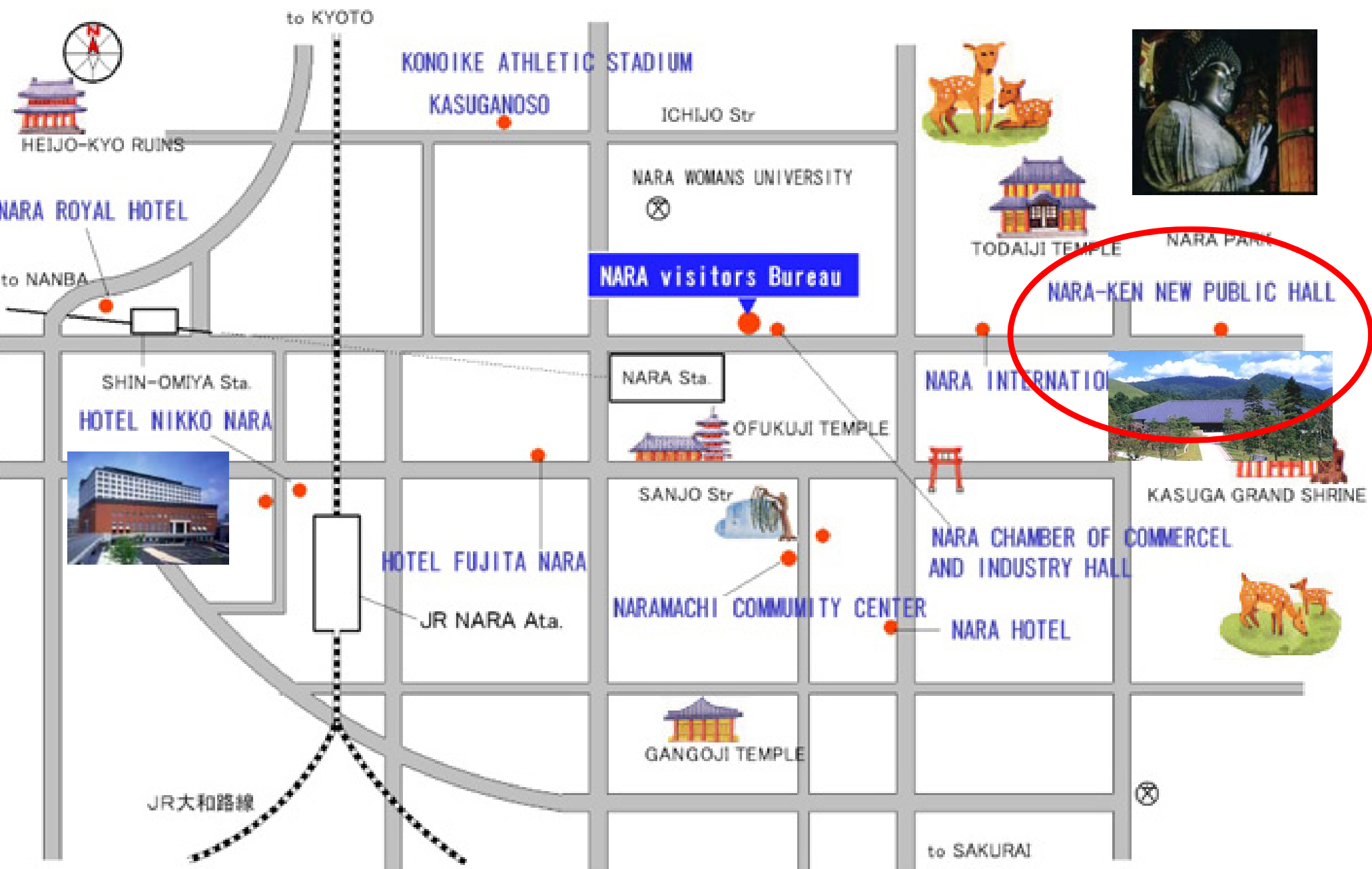

Nara Prefecture New Public Hall



Welcome to NOH Theater!

The Noh stage was designed to reproduce the traditional style established in Muromachi period (1336-1573).

MAX : 500 people, 855 m²

The near-side pillar (the watchdog pillar) is removable

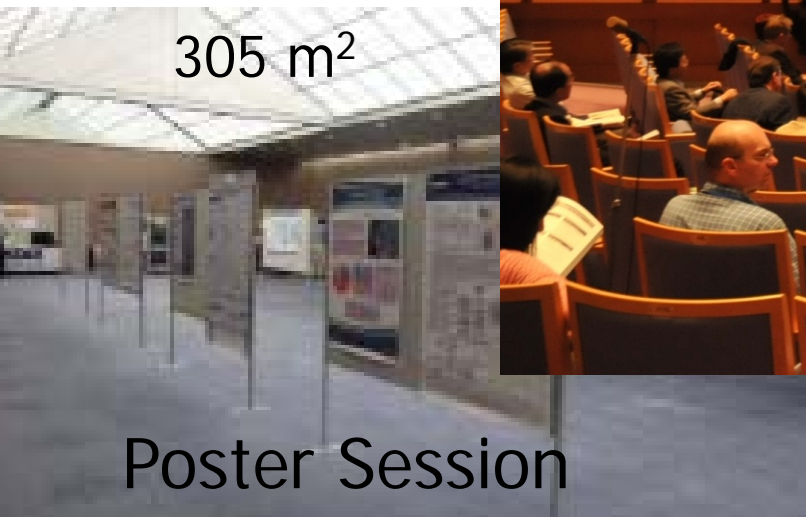

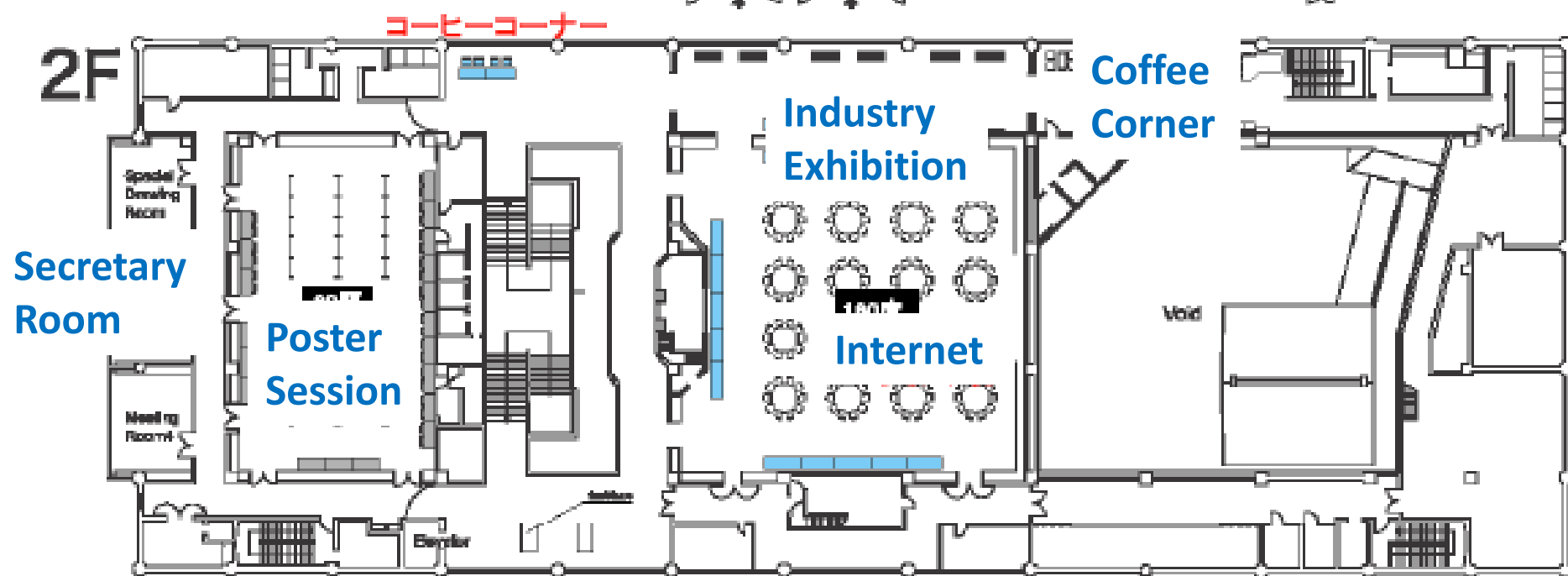
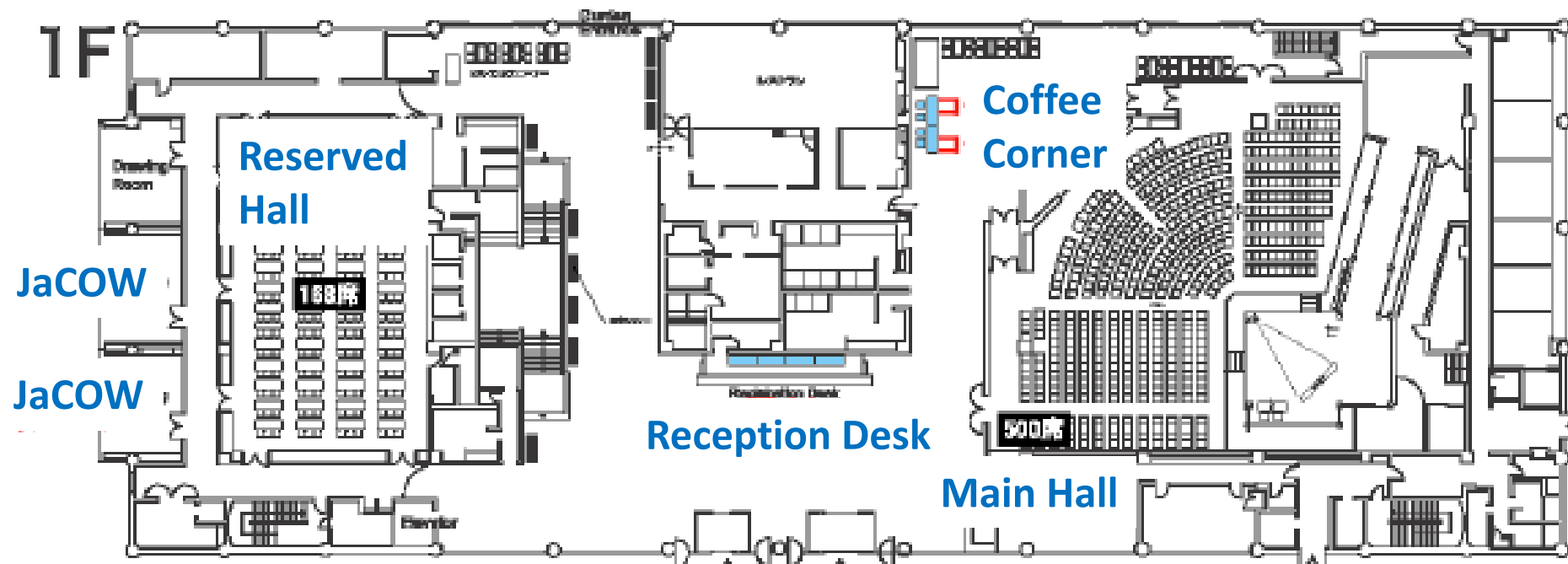

Conference Organization

- Conference Chair :
T. Shintake (SPring-8)
- Scientific Program Chair :
H. Hama (Tohoku U.)
H. Tanaka (SPring-8)
- Local Organizing Committee Chair :
H. Ohgaki (Kyoto U.)
Y. Otake (SPring-8)

Members of LOC

- Conference Secretary : T. Kii (Kyoto U.)
- JACOW, Proceedings : T. Tanaka (Nihon U.),
H. Zen (Kyoto U.), A. Shirakawa (KEK),...
- Industry Exhibition : E. Minehara (WREC)
- Laboratory Tours : T. Hara (SPring-8),
R. Kato (Osaka U.)
- Poster Sessions : K. Masuda (Kyoto U.),
N. Nishimori (JAEA)
- Oral Sessions : R. Hajima (JAEA),
M. Kato (UVSOR), Y. Hayakawa (Nihon U.)

*Advisers : Christine Petit-Jean-Genaz(CERN),
Jianhui Chen and Dong Wang(SINAP)*

Budget Estimation, Expenditure

	JPY	USD (=80JPY)	
Conference Venue	3,500,000	43,750	
Food & Beverage (welcome)	500,000	6,250	
Food & Beverage (Banquet)	5,000,000	62,500	Hotel Nikko Nara
Food & Beverage (coffee...)	1,000,000	12,500	
WEB (design ...)	1,000,000	12,500	
WEB (registration system)	400,000	5,000	
Industry Exhibition	1,500,000	18,750	
Laboratory Tour	2,000,000	25,000	
Invite & student support	5,300,000	66,250	JACOW, Speaker...
Poster, printings, shipping	1,800,000	22,500	CD or memory stick ..
Miscellaneous	2,250,000	28,125	IEC dinner, events ..
Total	24,550,000	306,875	400 attendees

Budget Estimation, Income

	Heads	USD	Sub total (USD)
Registration (delegate)	200	600	120,000
Registration (student)	100	300	30,000
Industrial Exhibition	40	3,000	120,000
Sponsorships (JASRI, KU...)		37,500	37,500
Laboratory Tours	200	30	6,000
Total			313,500

Accommodations



Hotel Nikko Nara has the largest number of rooms in the prefecture, and there are Japanese, Western, Chinese and Teppan restaurants. There are also separate baths for men and women.

Nara Hotel is located on a tree-covered hill in Nara Park, where herds of deer play. The hotel has been a noted establishment since its construction in 1909, with 101 years of history and tradition behind it.



Nara Washington Hotel Plaza

Hotel Fujita Nara



Other lots of hotels and Ryokan around Nara Station with reasonable prices.

World Heritage sites in Nara

Todaiji Temple

The Great Image of Buddha greets visitors. The world famous Todaiji Te...

Kofukuji Temple

The five-storied pagoda rises with a quiet dignity above the Deer Park...

Kasuga Taisha Shrine

Stone-lanterns line the road to the sanctuary Kasuga Taisha Shrine was...

Mt. Kasuga Primeval Forest

A mountain home of the gods Mt. Kasuga is a primeval forest of ever-gr...

Gangoji Temple

Temple featuring Mandala The home of a famous monk named Chiko who liv...

Heijo-kyo Palace Site

The ancient capital of Japan in the 8th century For 74 years starting ...

Yakushiji Temple

The eastern terminus of the Silk Road The 34m high Eastern Pagoda is t...

Toshodaiji Temple

Uchiwamaki - a ceremony in which paper fans are given away to ward off...

Horyuji Temple

Preserving the ideals of Prince Shotoku and a treasure house of ancien...