

Entry: CU40 **Date:**
Machine Name:
Cyclotron Model: MC17F Scanditronix.....
Institution: Istituto Nazionale Tumori.....
Address: V. Venezian 1- Milano - Italy.....
Tel: +39-2-2390-220.....
Fax: +39-2-2367-874..... **Web:**
E-mail: ebombar@tin.it.....
In Charge: E. Bombardieri and V. DeSanctis.....

ENTRY NO. CU41 **Date** January 3, 1996
Cyclotron Model Scanditronix MC-17
Institution Istituto dei tumori Fondazione G.Pascale
Address Via M. Semmola 80131 Napoli
Tel +39 81 5903229 **Telex**
Fax +39 81 5465797 **E-MAIL** ALFANO@NA.INFN.IT
In Charge: **Reported by:** Dr M Panico

HISTORY

Installation: 1994..... **First Beam:** 1995.....
Design/Construction by: Scanditronix.....
Funded by: Italian Health Service

HISTORY

MILESTONE DATES:
Installation February 1991 **First Beam** March 1991
DESIGN/CONSTRUCTION BY: Scanditronix Sweden
COST: Accelerator Facility 2.5Million \$
FUNDED BY: University/CNR/Pascale

USES

Isotope production for clinical activity80 %
 Isotope production for radiochemistry.....10 %
 Maintenance.....10 %
 %
 %
Total time: h/year

STATUS

STAFF: Operators4 Technicians2
BUDGET: Machine \$400,000 Funded by Univ/CNR/Pascale
TIME DISTRIBUTION: (e.g. basic research, isotope production, maintenance, etc.)
 (a)Basic research40 %
 (b)Isotopic production52 %
 (c)Maintenance8 %
 (d) %
 (e) %

CHARACTERISTIC BEAMS

Ions/energy/current:
 p / 14.2 MeV / 60 µA / 900 W.....
 d / 8.6 MeV / 60 µA / 900 W.....

CHARACTERISTIC BEAMS

Accelerated Ions	E/A (MeV/u)	Internal	External
(a) Protons	17		20
(b) Deuterons	7.4		

1994 µA-hours on target:8000s.....

EXPERIMENTAL FACILITIES

FACILITIES

SHIELDED AREA: Fixed:40 m² Moveable m²
Target Stations:8 **No. Served At Same Time:**1
OTHER FACILITIES: ANATECH, ROBOT, RB86
two Hot cells, Von Gahlen

REFERENCES

REFERENCES/NOTES

(a)
 (b)

PLAN VIEW OF FACILITY

PLAN VIEW OF FACILITY, COMMENTS

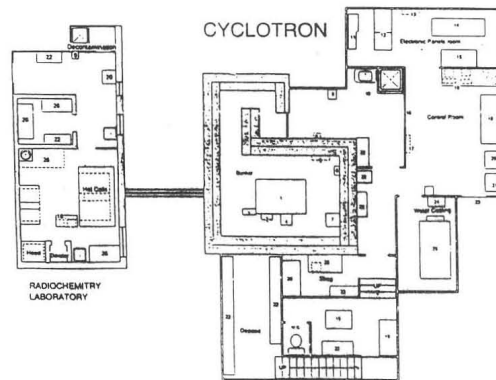

COMMENTS

.....

