

ENTRY NO. CU36 **Date** October, 1995
Cyclotron Model IBA Cyclone 1819
Institution Universität Ulm, Abt. Nuklearmed.
Address Robert Koch Str 8, D-89081 Ulm, Germany
Tel 0731-502-4501 **Telex**
Fax 0731-502-4503 **E-MAIL**
In Charge: Prof. Reske **Reported by:** Dr. Hartung

HISTORY
MILESTONE DATES:
Installation May & June 1995 **First Beam** 21/06/1995
DESIGN/CONSTRUCTION BY: Siemens/LBA
COST: Accelerator Facility
FUNDED BY: University of Ulm

STATUS
STAFF: Operators 1 **Technicians** 1
BUDGET: Machine Funded by
TIME DISTRIBUTION: (e.g. basic research, isotope production, maintenance, etc.)
 (a) Isotope production of positron emitters 100 %
 (b) $(^{18}\text{F}, ^{11}\text{C}, ^{13}\text{N}, ^{15}\text{O})$
 (c)
 (d)
 (e)

CHARACTERISTIC BEAMS

Accelerated Ions	E/A (MeV/u)	Current (part μA)	
		Internal	External
(a) Protons (H ⁻)	16-18		
(b) Deuterons (D ⁻)	7-9		

1994 μA -hours on target:

FACILITIES
SHIELDED AREA: Fixed: 25 m² Moveable: -- m²
Target Stations: 5 **No. Served At Same Time:** 2

OTHER FACILITIES:

REFERENCES/NOTES
 (a)
 (b)

PLAN VIEW OF FACILITY, COMMENTS

The routine productions of the positron emitting nuclides will be started in November 1995.

Entry: CU37 **Date:** 02-06-1998
Machine Name:
Cyclotron Model: MGC-20
Institution: Institute of Nuclear Research of the Hung. Acad.
Address: P.O.Box 51
Tel: (36)-52-417-266
Fax: (36)-52-416-181 **Web:** www.atomki.hu
E-mail: Z.Kormany@atomki.hu
In Charge: Dr. Z. Kormány, F. Tárkányi (head of Cycl. Dept.)

HISTORY
Installation: 1984-85 **First Beam:** Nov. 1987
Design/Construction by: NIEFFA St.Petersburg
Funded by: IAEA/Hungarian Government

USES

Isotope production	50	%
Nuclear spectroscopy	26	%
Nuclear astrophysics	13	%
Radiation hardness studies	8	%
Materials science	3	%
Total time: 2340		h/year

CHARACTERISTIC BEAMS
Ions/energy/current:
 P 14.5 MeV/40 μA
 D 10 MeV/50 μA
 ^4He 20 MeV/20 μA ^3He

EXPERIMENTAL FACILITIES
 Magnetic spectrographs
 Scattering chambers
 Facilities for radionuclide production
 PET

REFERENCES

PLAN VIEW OF FACILITY

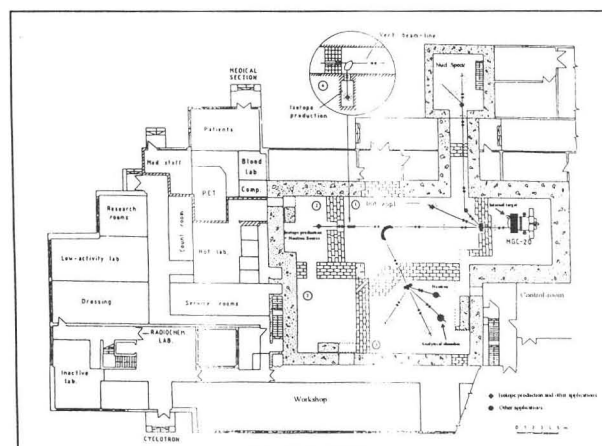

COMMENTS