

ENTRY NO. CUI22 Date  
 Cyclotron Model CS-22  
 Institution Amersham - Medi-Physics, Inc.  
 Address 900 Durham Ave., South Plainfield, NJ 07080  
 Tel 908-757-0500 Telex  
 Fax EMAIL  
 In Charge: R. Hubbard Reported by: W. Buela

**HISTORY**  
 MILESTONE DATES:  
 Installation July 1972 First Beam January 1973  
 DESIGN/CONSTRUCTION BY: The Cyclotron Corp.  
 COST: Accelerator Facility  
 FUNDED BY:

**STATUS**  
 STAFF: Operators 0 Technicians 4  
 BUDGET: Machine Funded by  
 TIME DISTRIBUTION: (e.g. basic research, isotope production, maintenance, etc.)  
 (a) Isotope Production 80 %  
 (b) Maintenance 20 %  
 (c) %  
 (d) %  
 (e) %

**CHARACTERISTIC BEAMS**

Accelerated Ions	E/A (MeV/u)	Current(part $\mu$ A)	
		Internal	External
(a) $H^+$	22	200	100
(b)			

1991  $\mu$ A-hours on target:  $7 \times 10^5$

**FACILITIES**  
 SHIELDED AREA: Fixed 85 m<sup>2</sup> Moveable 0 m<sup>2</sup>  
 Target Stations: 2 No. Served At Same Time: 1  
 OTHER FACILITIES:

**REFERENCES/NOTES**  
 (a)  
 (b)

**PLAN VIEW OF FACILITY, COMMENTS**

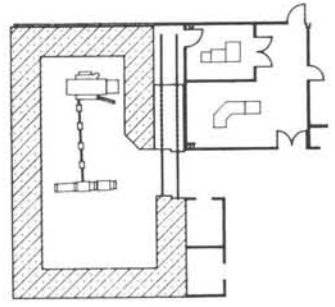

ENTRY NO. CUI23 Date  
 Cyclotron Model Cyclone 30  
 Institution Amersham - Medi-Physics, Inc.  
 Address 900 Durham Ave., South Plainfield, NJ 07080  
 Tel 908-757-0500 Telex  
 Fax EMAIL  
 In Charge: R. Hubbard Reported by: W. Buela

**HISTORY**  
 MILESTONE DATES:  
 Installation April 1989 First Beam Aug. 1989  
 DESIGN/CONSTRUCTION BY: ION Beam Applications  
 COST: Accelerator Facility  
 FUNDED BY:

**STATUS**  
 STAFF: Operators 0 Technicians 5  
 BUDGET: Machine Funded by  
 TIME DISTRIBUTION: (e.g. basic research, isotope production, maintenance, etc.)  
 (a) Isotope Production 80 %  
 (b) Maintenance 20 %  
 (c) %  
 (d) %  
 (e) %

**CHARACTERISTIC BEAMS**

Accelerated Ions	E/A (MeV/u)	Current(part $\mu$ A)	
		Internal	External
(a) $H^+$	30	500	2x250
(b)			

1991  $\mu$ A-hours on target:  $2 \times 10^6$

**FACILITIES**  
 SHIELDED AREA: Fixed 130 m<sup>2</sup> Moveable 0 m<sup>2</sup>  
 Target Stations: 4 No. Served At Same Time: 2  
 OTHER FACILITIES:

**REFERENCES/NOTES**  
 (a)  
 (b)

**PLAN VIEW OF FACILITY, COMMENTS**

